

Features

Fresh Mix Dispensers

- Space saving narrow 8" cabinet width.
- Variable speed hopper motors offer a wide range of product mix ratios (.75 to 6.6 grams of powder per second).
- Large easy-to-fill translucent hoppers insure quick and timely refilling.
FMD-1 = one 8 lbs.
FMD-2 = two 4 lbs. each
- Lighted graphics merchandise drinks for maximizing profits.
- Large hot water reservoir provides 4.2 gal./hour serving capacity.
- Adjustable legs & drip tray allows up to 7" opening for 20 oz. cups.
- Specially designed mixing system guarantees perfect beverages every time.
- Improved automatic rinse reduces run-on after beverage is dispensed.
- Designed to be easily serviced from front and top of machine.



Models FMD-1 & FMD-2
Dimensions: 30"H x 7.9"W x 21"D



*Model FMD-1 available
with optional
Hot Chocolate Display*

ITEM#

PROJECT

DATE

Model

*FMD-1
FMD-2*

Related Products

For current specification sheets and other information, go to www.bunnomatic.com.

BUNN recommends the use of our Easy Clear® Water Quality Systems to assure perfect taste.

Easy Clear® EQ-11-TL
Product No. : 30344.1001
Dimensions:
15⁷/₈" H x 3⁵/₈" W x 4¹⁷/₃₂" D

Easy Clear® ED-11-TL
Product No. : 30244.1001
Dimensions:
14³/₁₆" H x 5¹/₁₆" W x 5¹/₁₆" D



Features deluxe whipper chambers:

1. Robust whipper to ensure full flavor yield.
2. Specially designed self cleaning mixing chamber.
3. Exhaust fan to siphon off moisture that can cause powder buildup.
4. Hot water dispense for easy clean-out.
5. Quick disconnecting parts for thorough sanitizing.

*Single hopper
model shown.*

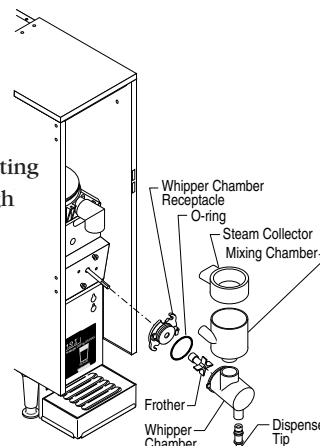

BUNN®

Corporate Offices
1400 Stevenson Drive
Springfield, Illinois 62703
Phone
800-637-8606
217-529-6601
Fax
217-529-6644
Technical Services
800-286-6070
Internet
<http://www.bunnomatic.com>

Western Regional Office
16431 Carmenita Road,
Cerritos, California 90701
Phone
562-926-0764
Fax
562-926-0858

Canadian Office
280 Industrial Parkway South
Aurora, Ontario, L4G 3T9
Phone
905-841-2866
Fax
905-841-2775

BUNN® practices continuous product research and improvement. We reserve the right to change specifications and product design without notice. Such revisions do not entitle the buyer to corresponding changes, improvements, additions or replacements for previously purchased equipment.

Patents
Apply



Dimensions & Specifications

Model	Product #	Volts	Amps	Tank Heater Watts	Total Watts	Brewing Capacity	Cu. Ft.	Shipping Weight	Cord Attached
FMD-1 BLK	SET00.0196	120	15	1700	1800	4.2 gal./hr.	7.6	63 lbs. (28.6 kg)	Yes
FMD-1 BLK	SET00.0203†	120	15	1700	1800	4.2 gal./hr.	7.6	69 lbs. (31.4 kg)	Yes
FMD-2 BLK	SET00.0200	120	15	1700	1800	4.2 gal./hr.	7.6	69 lbs. (31.4 kg)	Yes

† Model has "Hot Chocolate" display. Make-to-order item - requires longer lead time.

Electrical: Model requires 2-wires plus ground service rated 120V, single phase, 60 hz.

Plumbing: 20-90 psi (138-621 kPa) from a 3/8" (10 mm) or larger supply line. A shut-off valve should be installed in the line before the unit. Install a regulator in line when pressure is greater than 90 psi to reduce it to 50 psi. Supplied with 1/4" (6.4 mm) male flare fitting.

